



Studios & Space + Events

What we do

At our core are the fundamental aims to provide space to develop creative enterprise and to promote arts through events

CADS services include:

- provision of creative studios for rent
- exhibition & venue space for hire
- space brokering to provide access to empty spaces
- production facilities and project support





Music

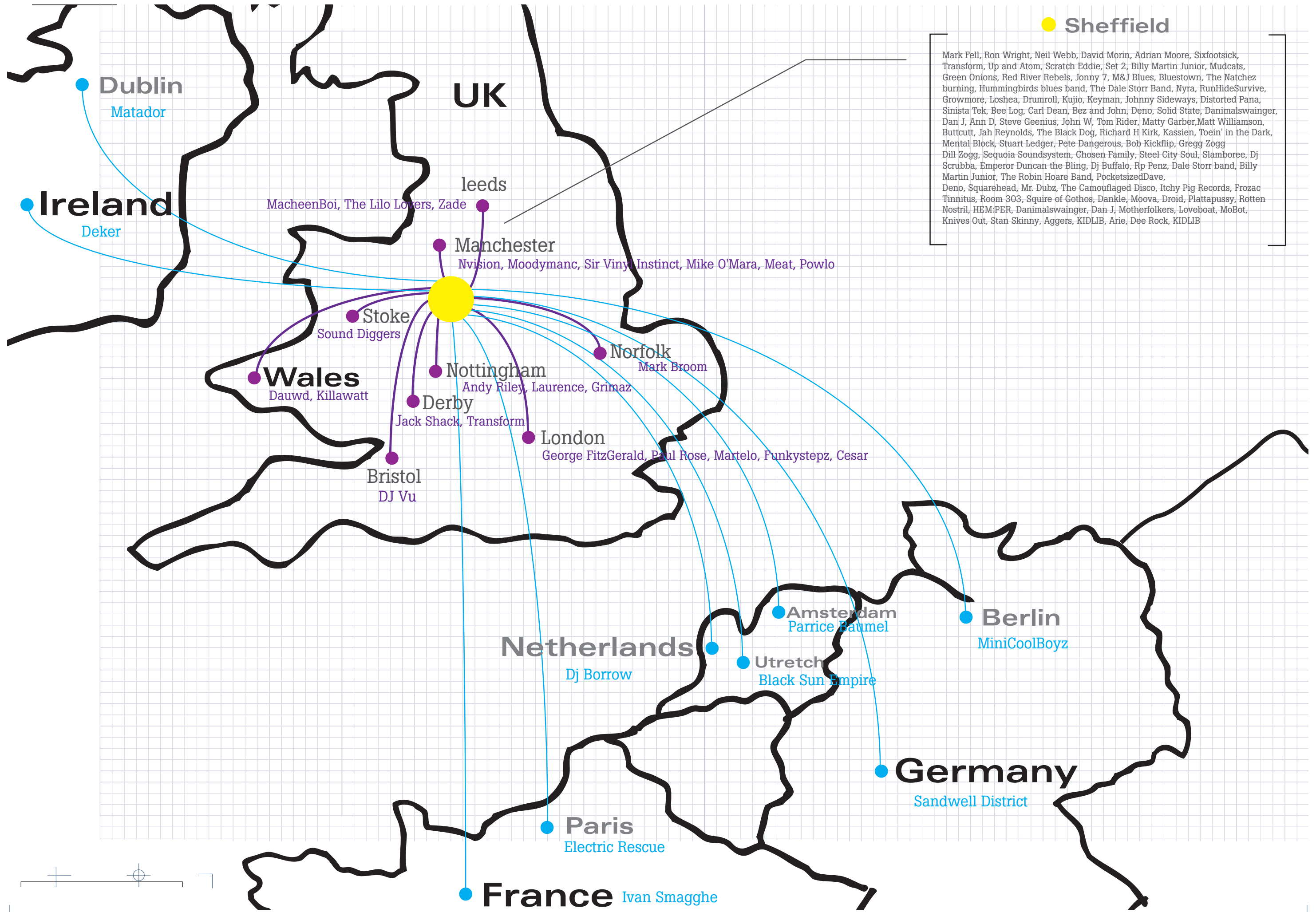

Art





Digital Art & New Media

Community

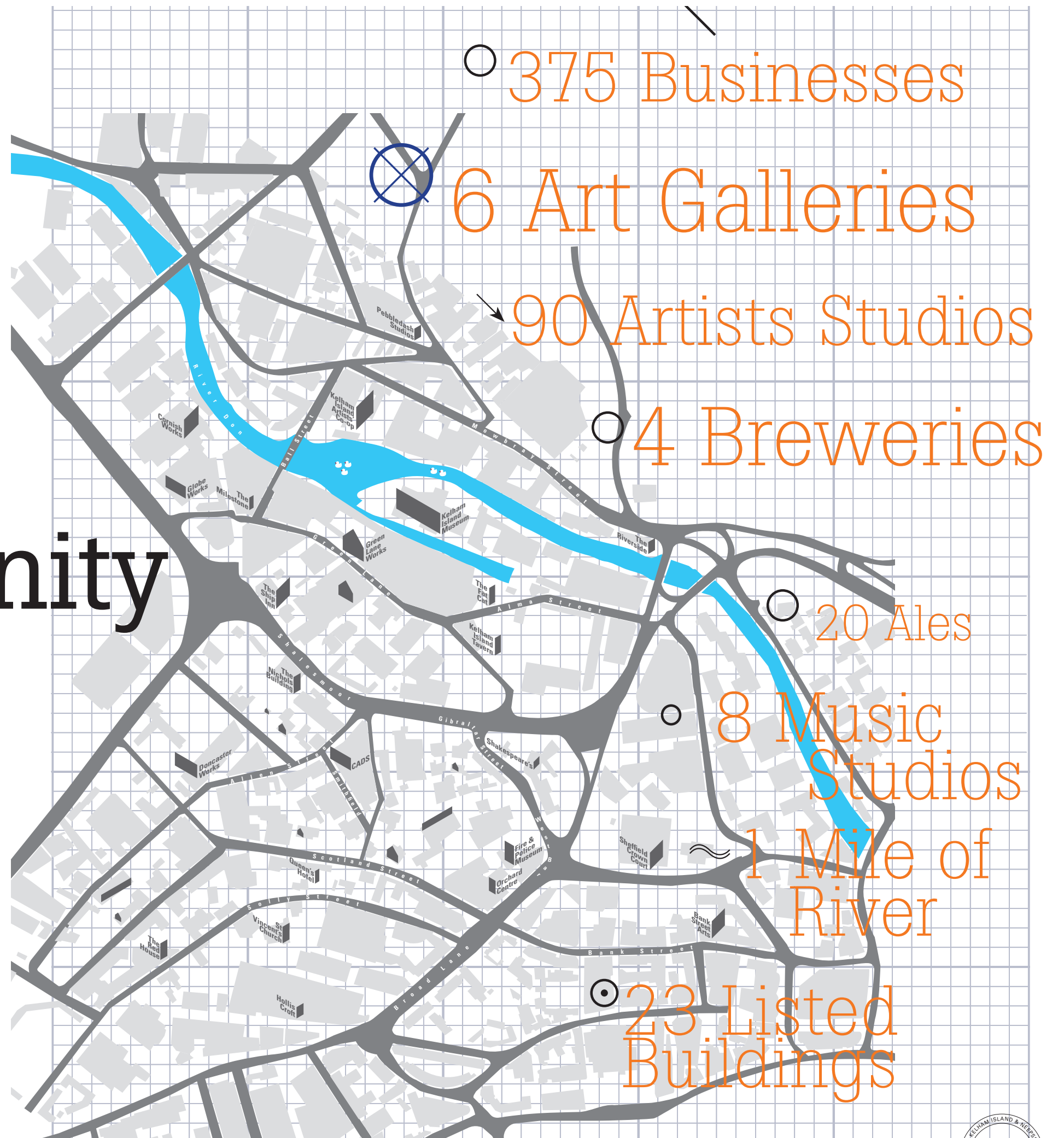













Equipment

Locations

From its beginning as a small arts complex in an ex-factory, CADS now runs studios and events across Sheffield in Shalesmoor, Kelham Island, the Creative Industries Quarter (CIQ) and the City Centre

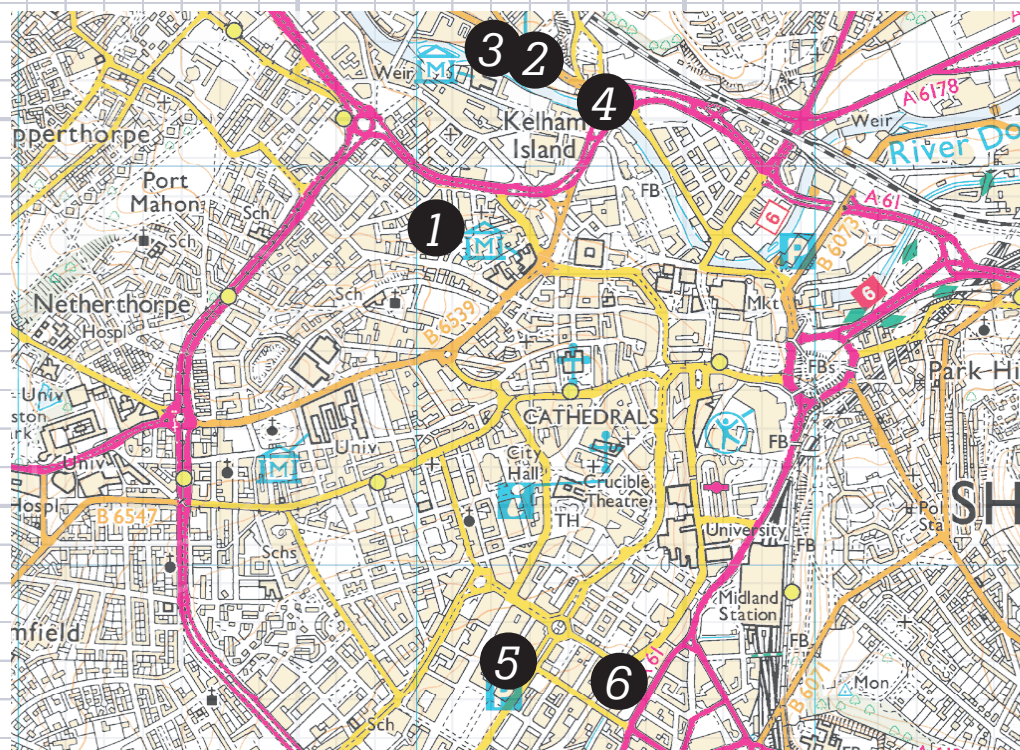

2009 - 1 location

3 studios, 750 sq ft

2014 - 6 locations

85 studios, 25,000+ sq ft!

CADS manages 6 studio clusters across the city:

Shalesmoor

[1] CADS Works –
Smithfield & Snow
Lane Studios

Kelham Island

[2] Pebble-dash Studios
[3] Clarence Works
[4] Penrose Works

City Centre

[5] Union Street
Centre

Creative Industries Quarter (CIQ)

[6] Avec Studios

**Space/Studio Hire
+ Event
- Running Costs**

**= Outreach
programmes
+ Area development**

Facts and Figures

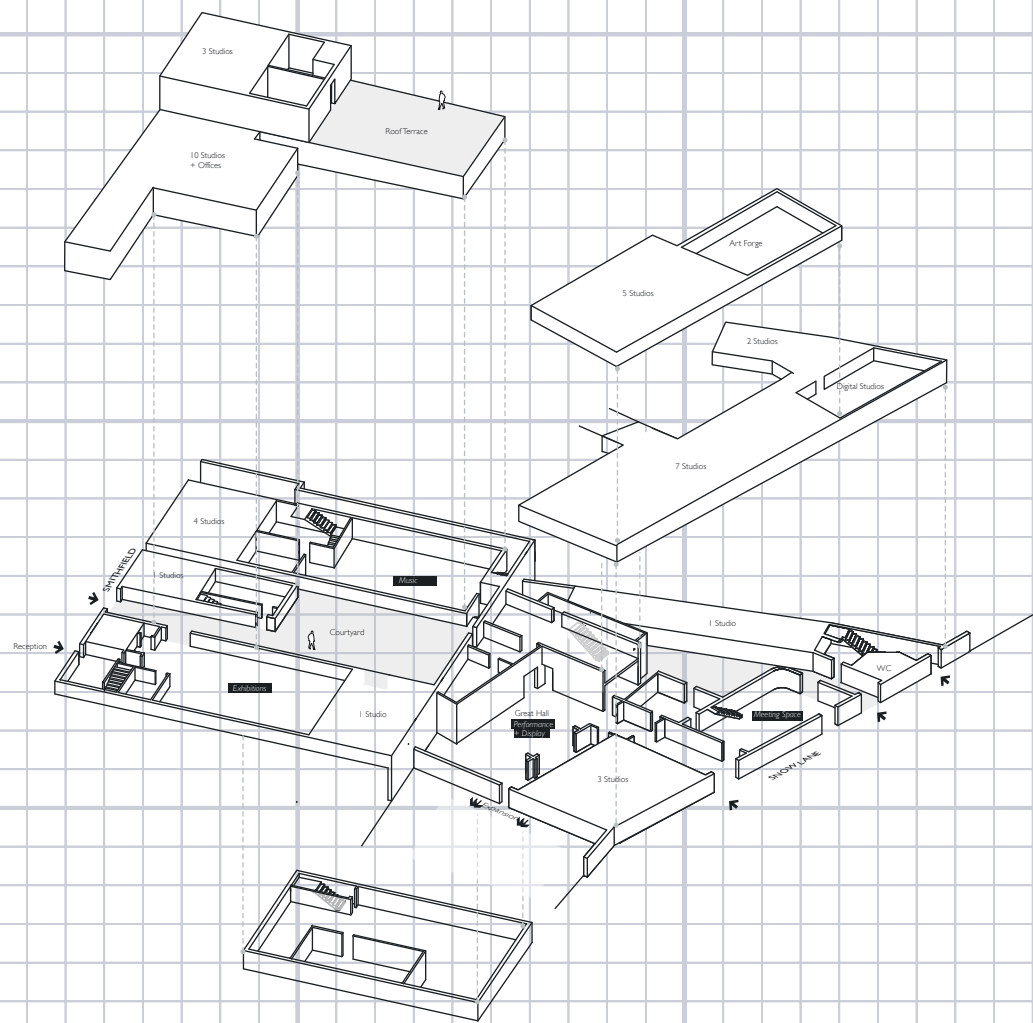

-In 2014 the number of CADS users has grown to over 100. Its resident community includes young and established artists, musicians, makers and start-up creative businesses

-CADS employs 3 full-time and 1 part-time members of staff and provides regular employment to more than 20 people

-CADS provides opportunities for work experience through numerous volunteer and paid internship programmes

2013 – 2014

12,000 visitors

40+ events

Supported projects

Since its launch in 2009 CADS has actively supported the following organisations and projects:

SKINN – a not-for-profit development agency for Shalesmoor, Kelham Island and Neepsend areas of Sheffield

ChopShop – a digital fabrication and design facility

Sheffield Art Forge – a platform for emerging artists and exhibitions

WaveLab – an open-access Digital Media Centre, now based in the Union Street Centre

Party for the People – a charity fund-raising initiative through on-line ticket sales and music events

The Night Kitchen – partnership of Party for the People and CADS, creating a venue space featuring art installations and space for creative workshops

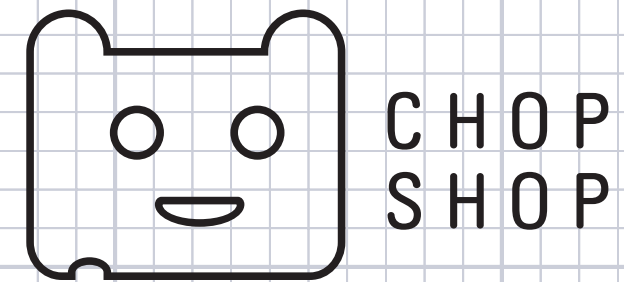

Community Programmes

Space CADets Residency Programme

– 6 weeks free studio space for creative people to develop an idea

Art Therapy – working with Sheffield Art Forge and 'SY Arts Community Arts Service' to deliver an art therapy programme for those most in need

Free Space – supporting 'Somewhereto' – an organisation set up to help young people access free space

CADS Space CADets Programme
 Got a project? Need space? Got no money? Why not become a space CADet?

Space CADets is a new project from the Creative Arts Development Space aimed at people who need it.

What we are offering :

- A free studio for 6 weeks
- Studio will be approximately 100-120 sqft (worth £35 P/W)
- A chance to showcase your project in one of our exhibition areas *
- A chance to showcase your project on the CADS website / Social media
- An opportunity to take on the studio full time at a discounted rate*

What we are looking for:

- New/ exciting/ innovative projects that can be completed in 6 weeks
- Any creative project will be considered
- People who would struggle to do their project without free space
- People who would be comfortable doing a small write-up of their project to
- Over 18s

What we need from you:

- Up to one sheet of A4 (500 words) detailing the project you would like to do would assist with this (Be creative, all proposals will be considered!)



Recent projects...

Enable Space Ltd – a partnership between CADS and Common People Initiative LTD– to deliver a Social Landlord Programme – bringing empty space back in use through space brokering



**Union Street Centre -
Coworking, Studios & Event Space**



Four floors of ex-office and retail space.
Union Street building looks set to be a
hive of creativity and social endeavour!

Now a home for:

- University of Sheffield
- Live Works – School of Architecture masters design studio, part of the Engaged University Programme
- Community Law – School of Law, part of the Engaged University Programme
- Studio Polpo – not for profit architecture practice
- Co-working space – run with Common People
- WaveLab – open-access Digital Media Centre
- Roundabout – homeless mediation service for young people
- Gallery – CADS space for exhibitions and workshops

...and collaborations

CADS works closely with Sheffield City Council, Sheffield universities, commercial businesses and community organisations



The
University
Of
Sheffield.



Sheffield City Council:

Contributing to discussions on creating a Renew Sheffield programme on Meanwhile Use

University of Sheffield:

Marcus Westbury visit – information and contributions

Mentoring advice

Project funding

Facilitating space for projects – Live Works, Community Law

Castlegate Report (see page 10 for details)

Part of the Engaged University Programme

Castlegate Empty Property Report –

CADS and Common People Initiative LTD have been commissioned by the University of Sheffield, part of the Engaged University programme, to map the existing empty capacity held within the Castlegate area and report on options for positive re-use

This forms part of the University’s role in engaging with city centre development and helping to support options for creative progress through positive re-use of urban space

To complete the next stage of the report, officers from Regeneration Division of Sheffield City Council are currently providing contributions and comments

Empty properties within the Castlegate Conservation Area

1. Castle House (Former Co-operative Store)

2. Castle House (Former Post Office)

3. Court House

4. Boardwalk

5. Jessop Photography Store

6. I Quarter

7. Castle Market

8. The Gallery

9. Riverside Court Hotel

10. Market Tavern Pub

11. SCC Warehouse

12. Hare and Hounds Pub

13. No1 Oriental Buffet

14. SCC Play Resource Centre

15. Q Park retail units

16. Carousel Amusements

17. Food Trader

18. The Cannon Hotel and Pub

19. The Hancock & Lant

1. Castle House (Former Co-op Store)

Address

Angel Street, S3 8LN

Previous Use

Former Department Store

Size

9,854 sq. m

Rateable value (year)

£295,000

Condition

★★★★☆

Building Status

Listed Building

Description

-Castle House - Former Department Store

-Large deep open plan spaces

-Large ground floor space with floor to ceiling windows

-Grand staircase connecting the floors

-A number of offices and large meetings rooms on the top floors

-Loading dock on the ground floor

-Goods lift

-Good condition and can be used for temporary events straight away

-Owner currently does not pay any rates as the building is listed

Potential Uses

-Events

-Pop-up retail

-Studio Spaces

14. SCC Play Resource Centre

Address

31-33 Nursery Street, S3 8GF

Previous Use

Shop and Premises

Size

Unknown

Rateable value (year)

Unknown

Condition

★★★★☆

Building Status

Unknown

Description

-Sign of people living there

-Relatively good condition

15. Q Park retail units

Address

3 Broad Street, S1 2BQ

Previous Use

Shop and Premises

Size

280 sq. m

Rateable value (year)

Unknown

Condition

★★★★☆

Building Status

Not Listed

Description

-3 retail shell units - 280 sq.m. in total area.

-Has never been used or fitted out

-Presumably no services installed

Potential Uses

-Events

-Pop-up retail

-Studio Spaces

Contact

CADS and Creative Art Development Space are trading names of CADS South Yorkshire Limited. A company Limited by Guarantee and a Registered Charity

*Registered in England and Wales. Company No. 08117742
Charity No. 1151884*

Registered Office: Studio 5.1, 7 Smithfield, Sheffield, South Yorkshire, S3 7AR

*Contact: Steve Rimmer - steve.rimmer@cadsonline.co.uk
- 0114 348 9421*

**www.cads-online.co.uk
info@cadsonline.co.uk**

twitter:

@CADS_Sheff

facebook:

/cadsonline.sheffield

Member of



Sheffield Chamber
of Commerce and Industry



Part-Financed by Key Fund and by
the European Union



Project Part-Financed
by the European Union

European Regional
Development Fund

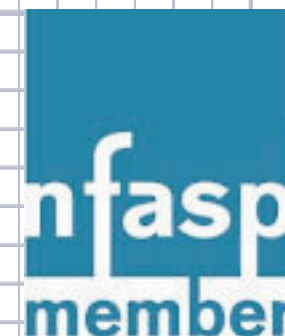

The National
Federation Of Artists
Studio Providers